

TYPE CE

端子兼腳架型電阻器

COLLARS WIREWOUND RESISTORS

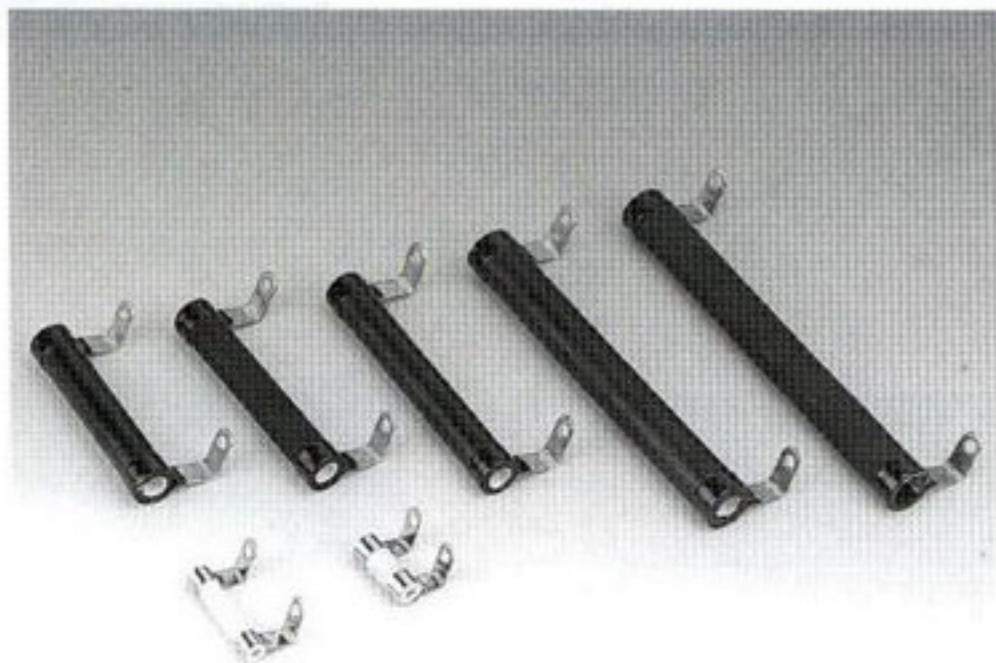

DIMENSIONS(MM)

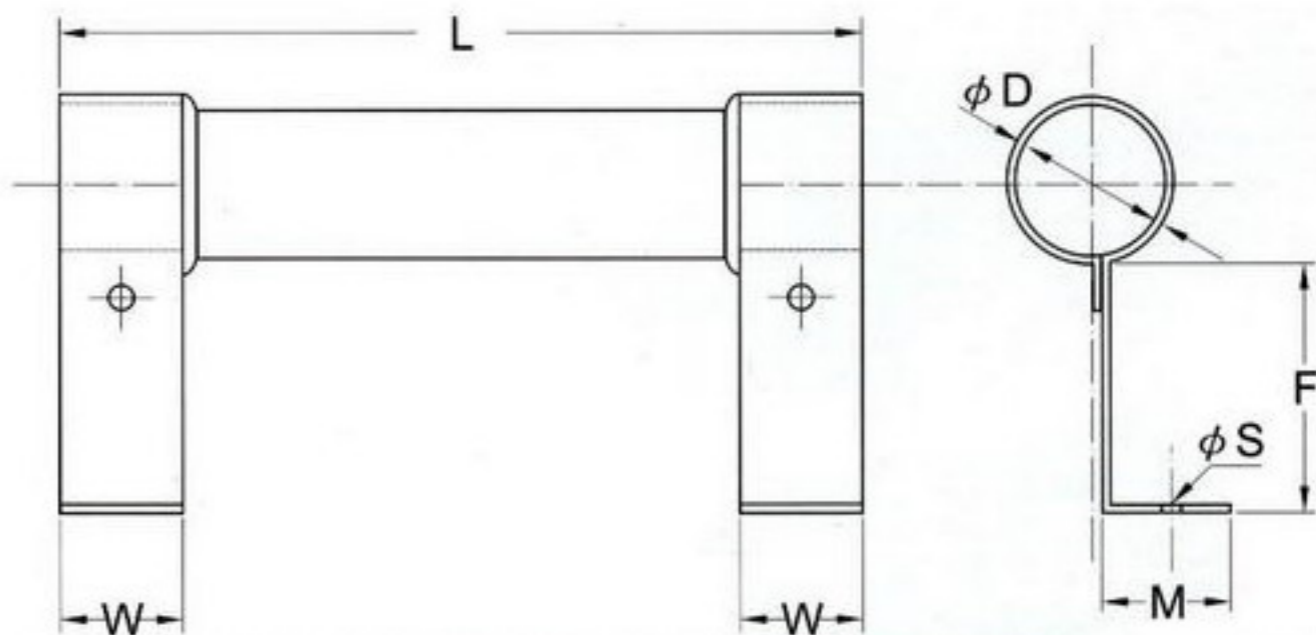

HOW TO ORDER

CE 100W N 80Ω J
 TYPE RESISTANCE TOLERANCE

In case of Non-inductive type, use the N

TYPE	電阻值範圍(Ω) RESISTANT RANGE	寸法 DIMENSIONS(mm)						
		L	D	d	M	W	φS	F
CE 5W	0.1Ω~5K	30	12	6	17	8	5.2	12
CE 10W	0.1Ω~10K	45	12	6	17	8	5.2	12
CE 15W	0.1Ω~15K	45	15	8	17	8	5.2	12
CE 20W	0.1Ω~20K	50	19	10	21	10	5.2	20
CE 30W	0.1Ω~30K	75	19	10	21	10	5.2	20
CE 40W	0.1Ω~40K	90	19	10	21	10	5.2	20
CE 50W	0.1Ω~50K	75	30	16	30	15	7.5	20
CE 60W	0.2Ω~60K	90	30	16	30	15	7.5	20
CE 80W	0.2Ω~80K	115	30	16	30	15	7.5	20
CE 100W	0.5Ω~100K	140	30	16	30	15	7.5	20
CE 120W	0.5Ω~120K	163	30	16	30	15	7.5	20
CE 150W	0.5Ω~150K	195	30	16	30	15	7.5	20
CE 200W	0.5Ω~200K	254	30	16	30	15	7.5	20
CE 250W	0.5Ω~250K	303	30	16	30	15	7.5	20